

Classic 3

C3NR200

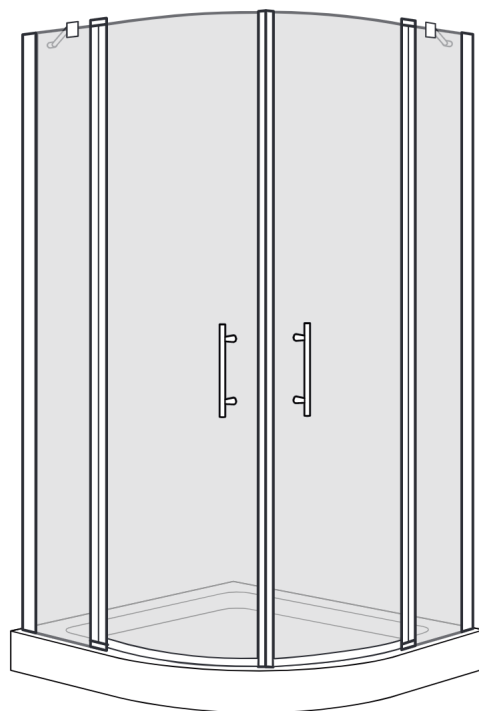

DE Montageanleitung
EN Installation instructions
FR Instruction de montage

Achtung! Gläser niemals ungeschützt auf den Boden stellen. Verletzung der Glaskante führt zu Glasbruch.

Caution! Never put glass walls on the floor without protection. Damaging the glass edges results in breaking of the glass.

Attention! Jamais placer des parois de douche en verre au sol sans protection. Des verres endommagés casseront.

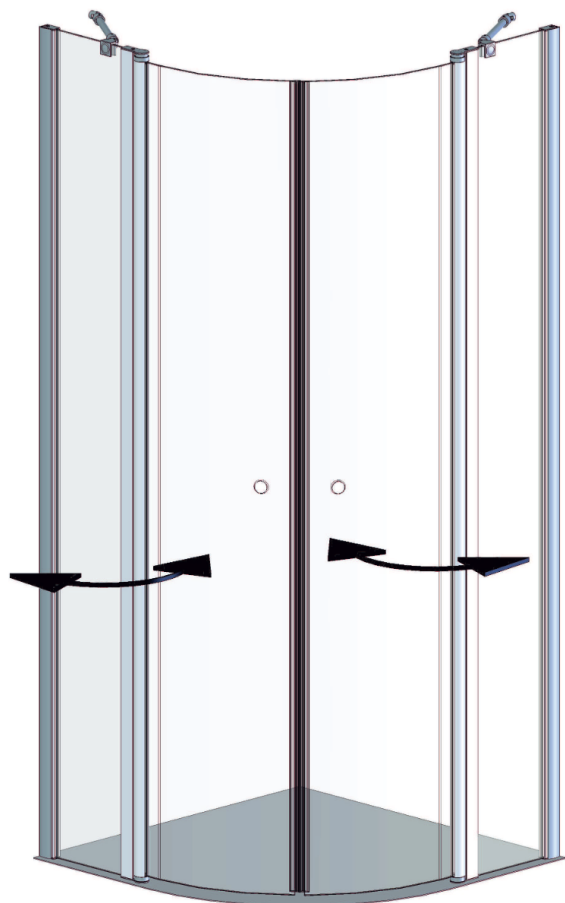

Die abgebildeten Formen der Profile und Griffe dienen der schematischen Darstellung und entsprechen nicht dem tatsächlichen Lieferumfang!

Mitgeliefertes Montagematerial
supplied assembly material
matériaux pour assemblage

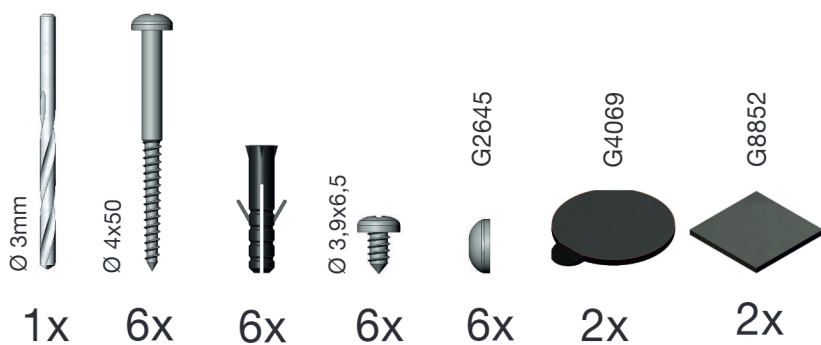

Zum Aufbau benötigen Sie
For mounting you need
Pour l'installation il vous faut



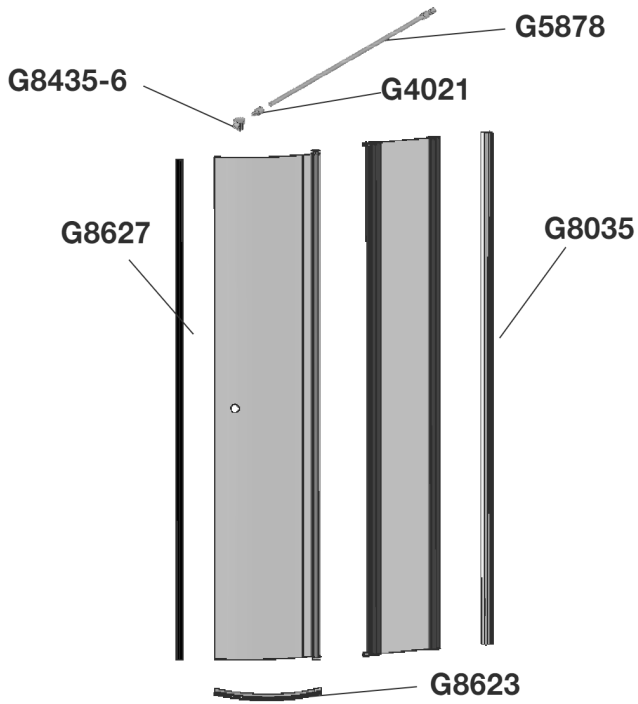

1

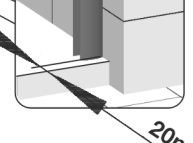
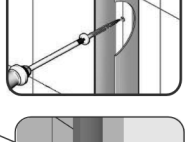
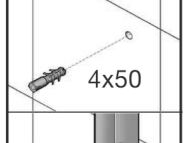
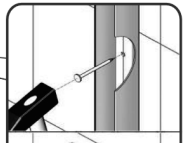
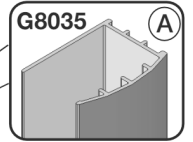
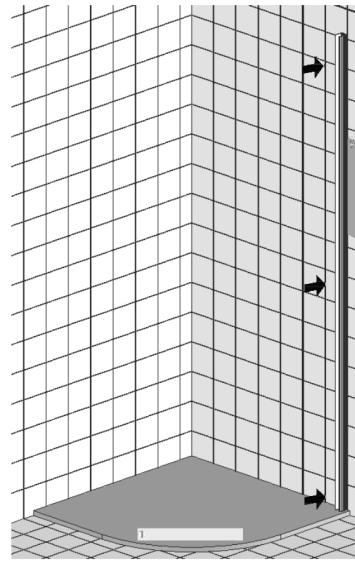

Bauteil rechts montiert
(Links montiert = spiegelbildlich)
element mounted right-hand
(Left-hand mounting = mirror inverted)
élément monté à droite
(à gauche = renversé)

2

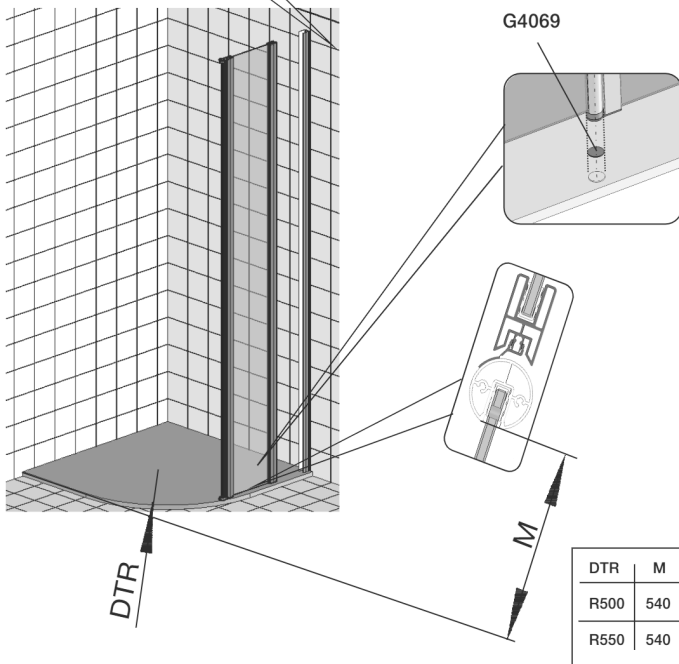
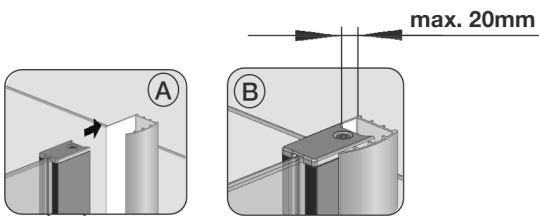

3

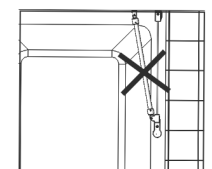
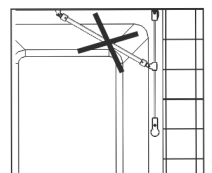
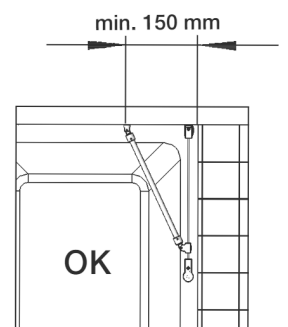
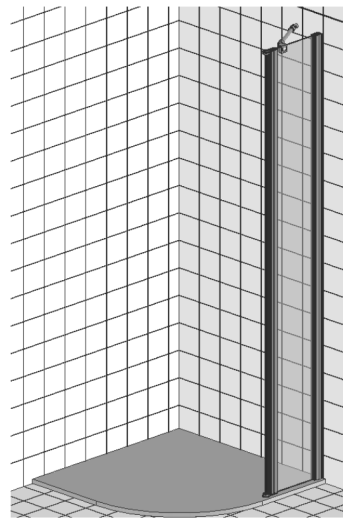

4

max. 20mm

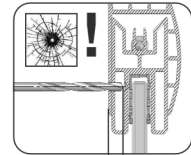
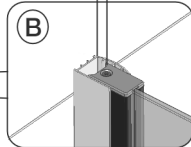
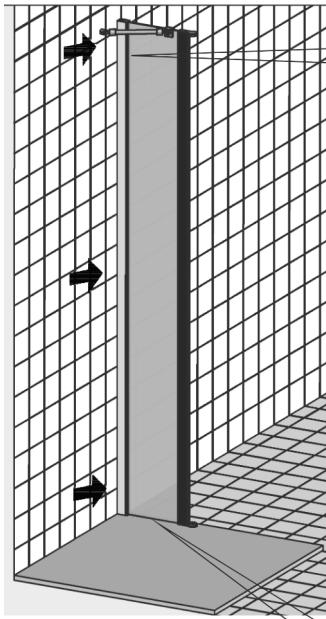

max. 6,5 mm

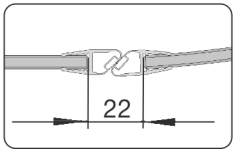
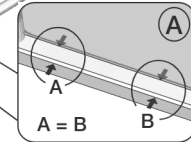
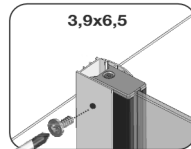
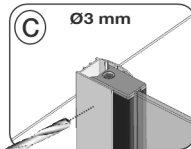

5

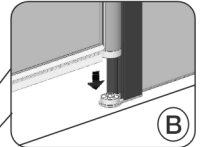
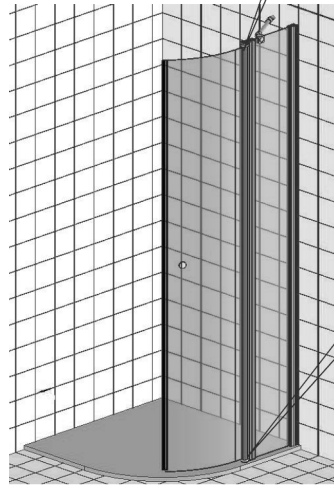
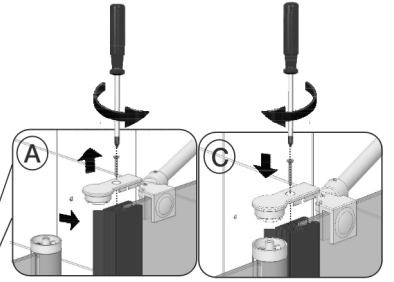

6



Magnetprofil G8627 nur unten kürzen.

Magnet profile G8627 only shorten at bottom

Profilé magnétique raccourcir au bout au-dessous seulement.

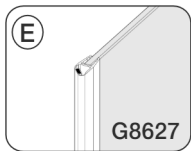
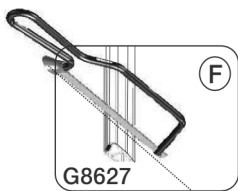
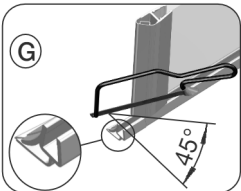
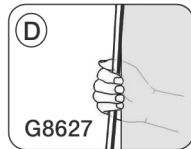
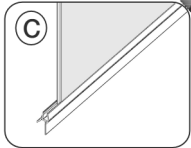
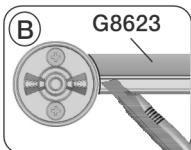
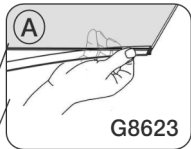
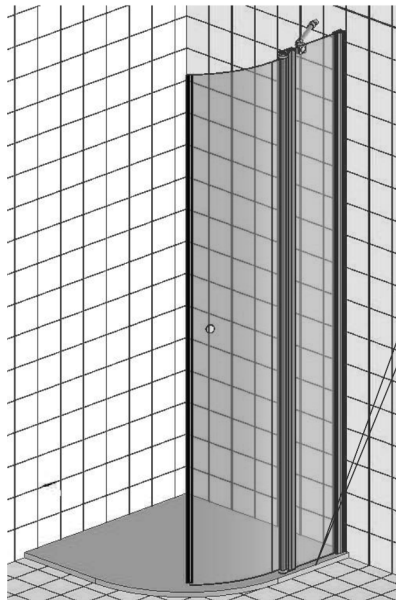

7

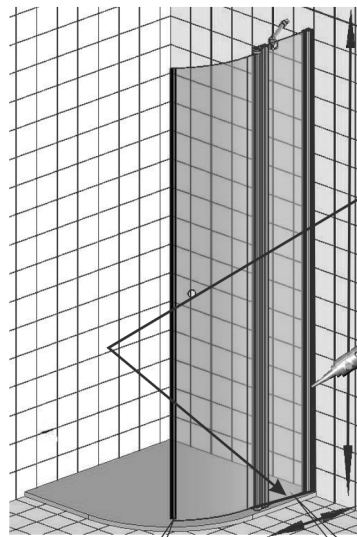
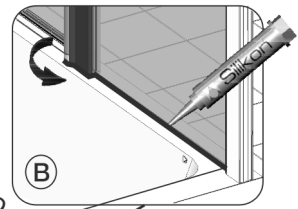

Stop

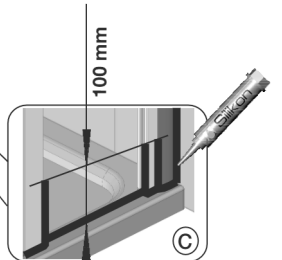
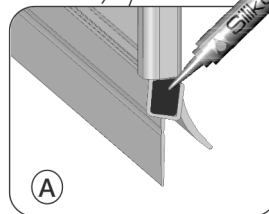

Montage auf Duschboden

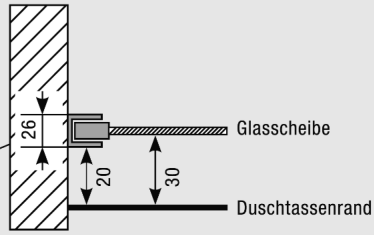
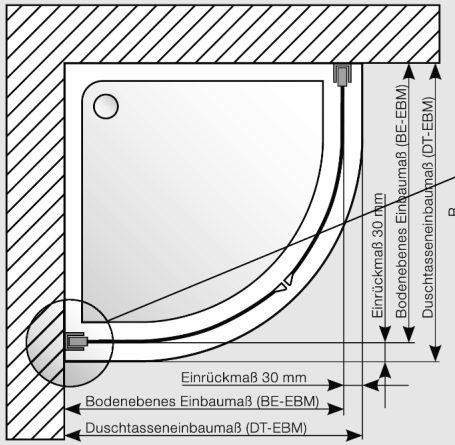

| DT | DT-EBM | BE-EBM |
|------|------------|-----------|
| 800 | 785 - 805 | 755 - 775 |
| 900 | 885 - 905 | 855 - 875 |
| 1000 | 985 - 1005 | 955 - 975 |

Montage Bodeneben

