

# Classic 3

C3NN100 / C3NN102 / C3NF100 / C3NC100 / C3NC120 / C3NC140

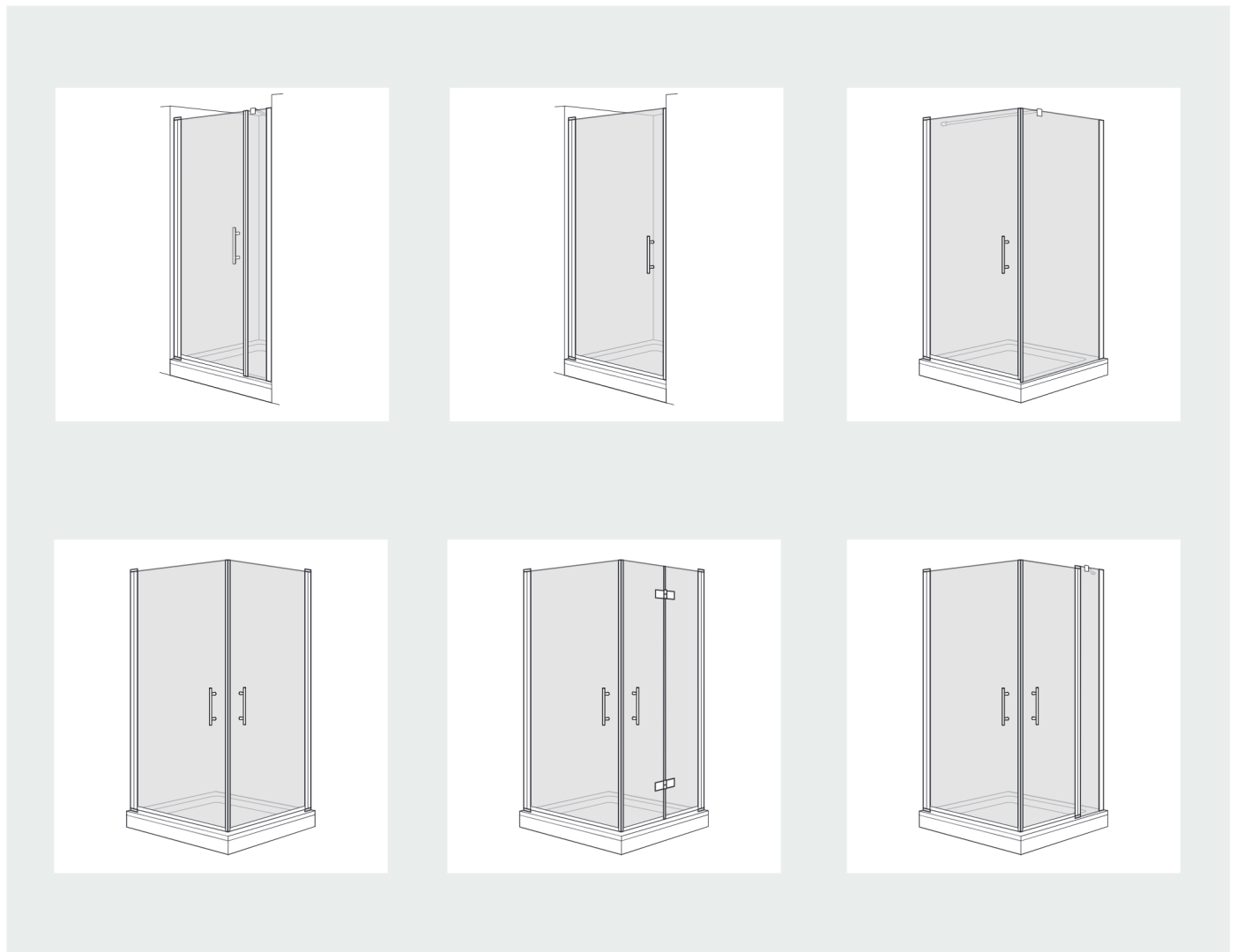

DE Montageanleitung  
EN Installation instructions  
FR Instruction de montage

**Achtung!** Gläser niemals ungeschützt auf den Boden stellen. Verletzung der Glaskante führt zu Glasbruch.

**Caution!** Never put glass walls on the floor without protection. Damaging the glass edges results in breaking of the glass.

**Attention!** Jamais placer des parois de douche en verre au sol sans protection. Des verres endommagés casseront.

Mögliche Einsatzgebiete des Elements WDX100:  
(MAL = Montageanleitung)

Nische, WDX200+WDXAN1928



Fronteinstieg, WDX100+WDX900

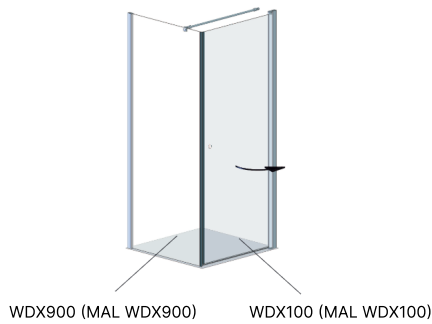

Eckeneinstieg, 2x WDX100 oder WDX100+WDX200

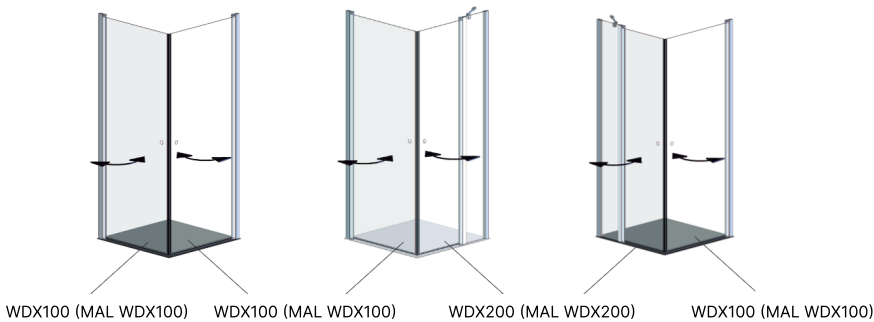

Die abgebildeten Formen der Profile und Griffe dienen der schematischen Darstellung und entsprechen nicht dem tatsächlichen Lieferumfang!

Mitgeliefertes Montagematerial  
supplied assembly material  
matériaux pour assemblage

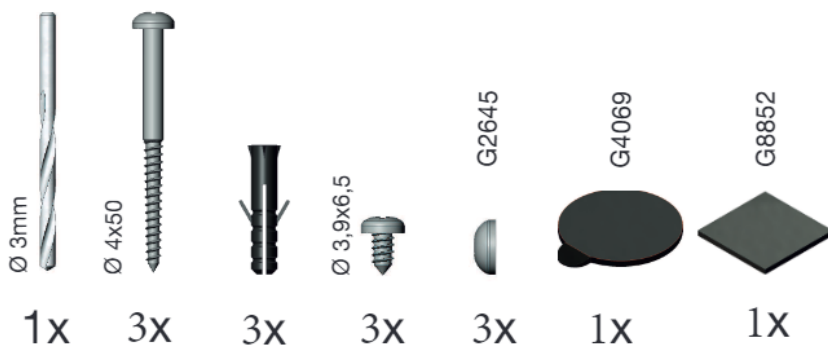

Zum Aufbau benötigen Sie  
For mounting you need  
Pour l'installation il vous faut



G8627

G8035

G8623

1

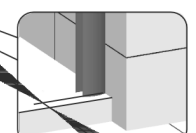
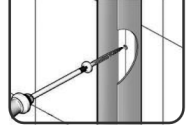
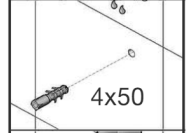
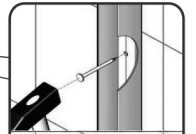
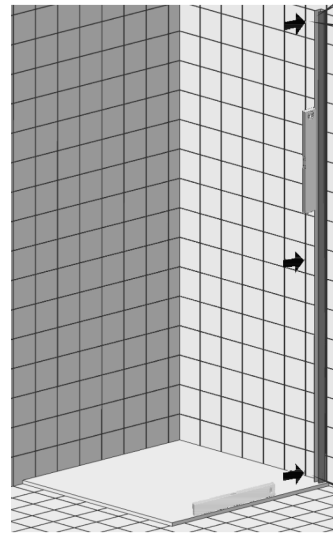
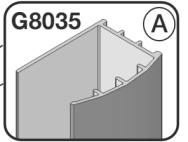

Montageanleitung für Rechtsanschlag  
(Linksanschlag = spiegelbildlich)

Assembly instructions for righthand mounting  
(left hand mounting = mirror inverted)

instruction d'assemblage pour charnière à droite  
(à gauche = inversé latéralement)

20mm

2

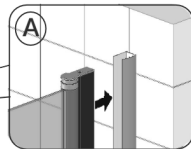
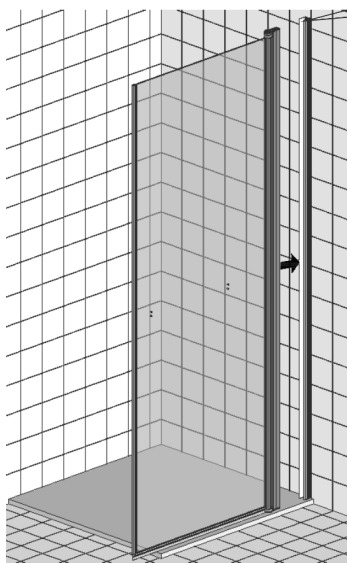

max. 20mm

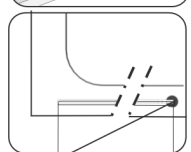
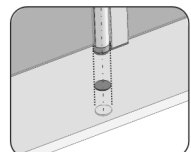
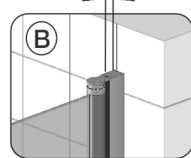

G4069

Tuer

3

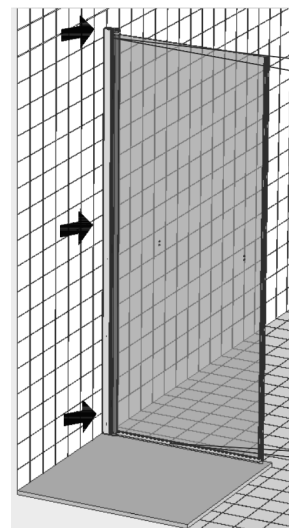

max. 20 mm

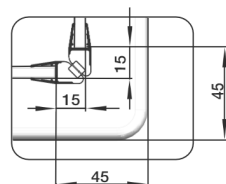
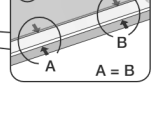
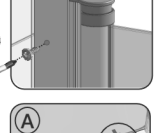
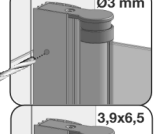
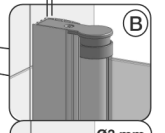

4

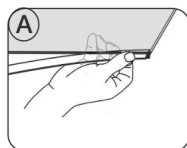
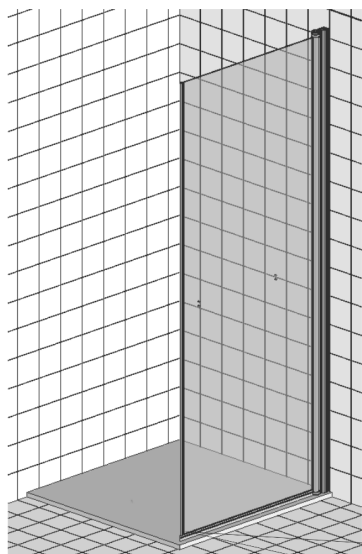

G8623

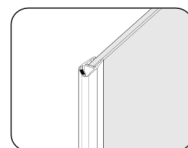
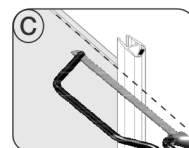
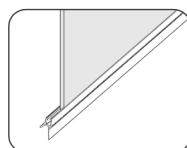

G8627

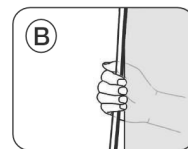

G8627

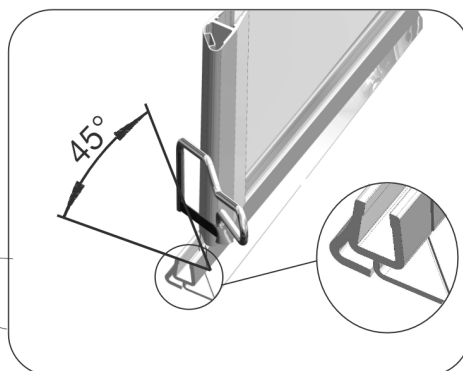

5

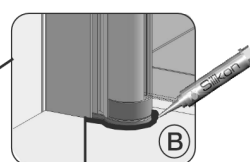
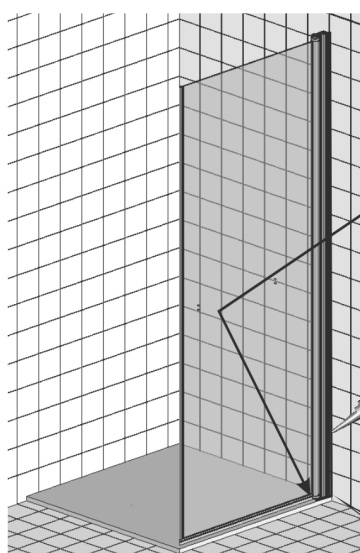

**STOP!**

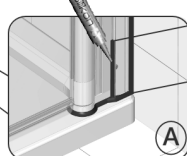

100 mm

Nischenmontage / MOUNTING WALL TO WALL

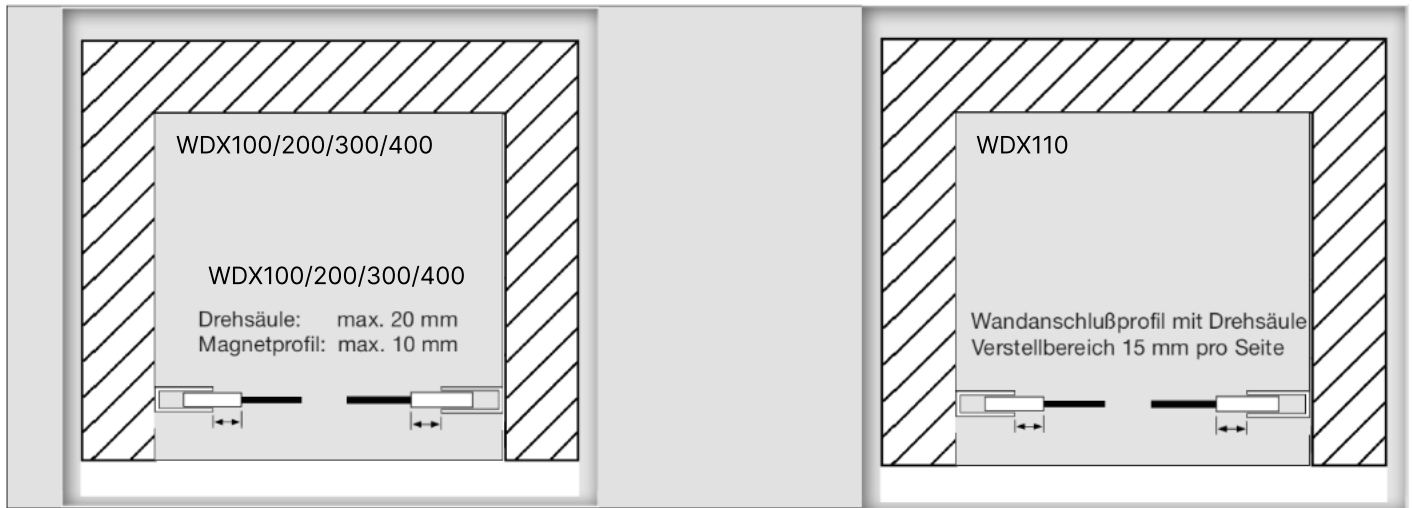

Montage Fronteinstieg mit Seitenteil / Eckeinstieg / MOUNTING FRONT ENTRY / CORNER ENTRY

Montage auf Duschkabine / Montage auf Duschtasse

DT	DT-EBM	BE-EBM
800	785-805	755-775
900	885-905	855-875
1000	985-1005	955-975
1200	1185-1205	1155-1175
1400	1385-1405	1355-1375

