

Absender / Firmenstempel | Sender / Company stamp  
Expéditeur / cachet de société | Mittente / Timbro della ditta:

Ansprechpartner | Contact | Responsable | Interlocutore:

Grosshandel | Wholesaler | Grossiste | Grossista:

Kommission | Commission | Commissione:

Auftrags Nr. | Order No. | Ordre No. | N°. d'ordine

Glas Nr. | Glass No. | Verre No. | Vetro N°:

Traversenart | Kind of stabilising bar | Type de traverse | Tipo di traversa

Farbe Nr. | Colour No. | Couleur No. | Colore N°: 062 070

Handtuchhalter | Towel-Rack | Porte serviette | Portasciugamani:  
Nr. | No. | No. | N°

Länge | Length | Longueur | Lungo

Einbauhöhe | Fixing height | Hauteur de fixation | Altezza di fissaggio:  
mm

Silikonfarbe Wand

Silikonfarbe Boden

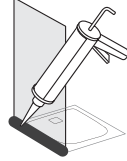
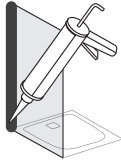

Weiss / White  
Blanc / Binaco  
711102.001

Grau / Grey  
Gris / Grigio (Manhattan)  
711102.030

Anthrazit / Anthracite  
Antracite / Antracite  
711102.217

Schwarz / Black  
Noir / Nero  
711102.076

\* Silikonfarbe Nr.  
Silicone Colour No.  
Couleur silicone No.  
Colori del silicone N°

\* siehe Zusatzblatt | see additional sheet  
voir feuille supplémentaire | vedi foglio aggiuntivo

Bitte um Kostenvoranschlag gemäss Angaben  
Send me an offer according the specifications  
Demande d'offre selon données ci-dessus  
Di farmi un preventivo-rispetto a questo box doccia

Diese Vorlage gilt bereits als Auftrag  
Ordering according the mentioned specifications  
Commande selon données ci-dessus  
Questo progetto e valido come ordine

Datum | Date | Date | Data:

Unterschrift | Signature | Signature | Firma

Masse (in mm) hier eintragen | Here to put down measures (in mm)

Indiquez ici les mesures (en mm) | Inserire le misure (in mm)



Nur auf technisch geeigneten Untergrund montierbar, d.h. Reibfest, tragfähig, formbeständig, sauber, trocken und frei von haftungsmindernden Bestandteilen.

Only for mounting on a technically suitable base, i.e. friction resistant, load bearing, dimensionally stable, clean, dry and free of adhesion reducing components.

A installer uniquement sur une base techniquement appropriée, c'est-à-dire résistante au frottement et porteuse, stable, propre, sec et sans composants réduisant l'adhérence

Montaggio solo su una base tecnicamente idonea, cioè resistente all'attrito e portante, dimensionalmente stabile, pulito, asciutto e privo di componenti che riducono l'adesione

PanElla (Decor-Stone)

Keramikfliesen  
ceramic tiles  
carreaux céramiques  
piastrelle di ceramica

Andere | Other | Autres | Altro

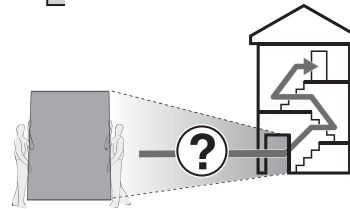
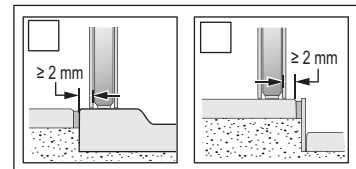
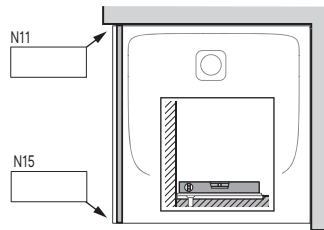
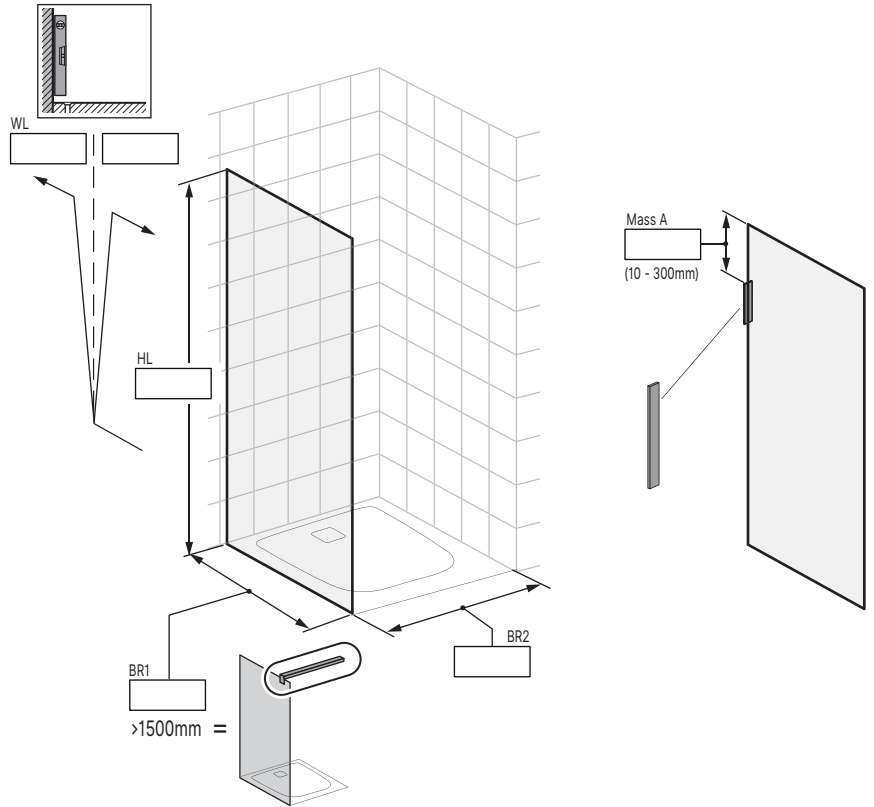

Platz für weitere Informationen (z.B. Schrägen, Ausschnitte) | Place for further information (e.g. slope, cut-out) |

Place pour informations supplémentaires ( biais, découpes) | Spazio per altre informazioni (taglio obliquo, taglio angolare)

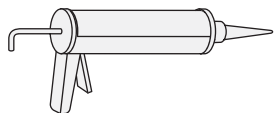

Weiss / White  
Blanc / Binaco  
**711102.001**



Jasmin / Jasmin  
Jasmin / Jasmin  
**711102.002**



Bahama / Bahama  
Bahama / Bahama  
**711102.005**



Grau / Grey (Manhattan)  
Gris / Grigio (Manhattan)  
**711102.030**



Schwarz / Black  
Noir / Nero  
**711102.076**



Braun / Brown  
Brun / Marrone  
**711102.181**



Anthrazit / Anthracite  
Anthracite / Antracite  
**711102.217**



Beige / Beige  
Beige / Beige  
**711102.238**



Hellgrau / Light Grey  
Gris clair / Grigio chiaro  
**711102.242**



Betongrau / Concrete-grey  
Gris-béton / Grigio cemento  
**711102.243**



Basalt / Basalt  
Basalt / Basalt  
**711102.256**



Dunkelgrau / Dark grey  
Gris foncé / Grigio scuro  
**711102.257**



Schiefergrau / Slate Grey  
Gris ardoise / Grigio Ardesia  
**711102.269**



Aluminium / Aluminium  
Aluminium / Alluminio  
**711102.270**



Edelstahl / Stainless steel  
Acier inoxydable / Acciaio inossidabile  
**711102.271**



Kirsche/ Cherry  
Cerise / Ciliegia  
**711102.272**



Eiche hell/ Light oak  
Chêne clair / Rovere chiaro  
**711102.273**



Eiche dunkel/ Dark oak  
Chêne foncé / Rovere scuro  
**711102.274**



Doussie/ Doussie  
Doussie / Doussie  
**711102.275**